

## VANNE POUR FONTAINE FOUNTAIN VALVE

### FONCTIONNALITÉS ET AVANTAGES / FEATURES & BENEFITS

#### DESIGN :

With its patented push-button design which allows for front access stream adjustment as well as cartridge and strainer access, this valve offers the ultimate in ease of maintenance.

#### VALVE :

The push-button activated valve offers the only all stainless steel valve body that is machined out of solid bar stock, is fully serviceable through the front of the push button assembly offering access to the water control cartridge and integral water supply strainer, and with front access to the water stream height adjustment for easy maintenance without having to remove the valve. Operating pressure range of 30 to 90 psi (2.1 to 6.2 bar).

#### PUSH BUTTON :

All chrome plated brass push button resists vandalism by allowing it to spin without unscrewing.



### OPTIONS

Valve Repair Kit for EU-SP-5874 : Model EU-SP-VRK5874, valve repair kit for Model EU-SP-5874.

### UTILISATIONS / APPLICATIONS

Specifically, this type of valve/button assembly is used as a replacement valve for many Haws fountains, whether it is to replace an existing EU-SP-5874 valve or to change out the older style EU-SP-5872 valve assembly.

Haws manufactures drinking fountains, faucets and electric water coolers to be lead-free by all known denitions including NSF/ANSI/CAN 61- Section 9, NSF/ANSI/CAN 372, California Proposition 65, and the Federal Safe Drinking Water Act. Product is compliant to California Health and Safety Code 116875 (AB 1953-2006), and NSF/ANSI/CAN 61 :  $Q \leq 0.5$ .

### CARACTÉRISTIQUES / SPECIFICATIONS

Cette vanne de fontaine en acier inoxydable est activée par bouton-poussoir. Entretien facile sans avoir à retirer la vanne. Pression : de 30 à 90 psi (2,1 à 6,2 bars).

Model **EU-SP-5874PBF** push-button activated fountain valve is the only all stainless steel valve body that is machined out of solid bar stock, is fully serviceable through the front of the push button assembly offering access to the water control cartridge and integral water supply strainer, and with front access to the water stream height adjustment for easy maintenance without having to remove the valve. Operating pressure range of 30 to 90 psi (2.1 to 6.2 bar).

### PRODUITS COMPATIBLES / COMPATIBLE PRODUCTS

|              |            |
|--------------|------------|
| EU-1001      | EU-1109.14 |
| EU-1001MS    | EU-1117L   |
| 1001HPS      | EU-1117LN  |
| 1001HPSMS    | EU-1119    |
| EU-1011      | EU-1119.14 |
| EU-1011MS    | EU-1311    |
| EU-1011HPS   | EU-1501    |
| EU-1011HPSMS | EU-3377    |
| EU-1105      | EU-3377G   |
| EU-1107L     | EU-3377BF  |
| EU-1109      | EU-3377BFG |

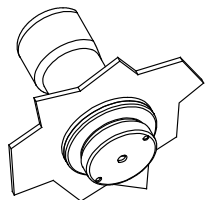

ASSEMBLED EU-SP-5874PBF  
(FLUSH MOUNT APPLICATION ONLY)

SEE SHEET 2 OF 3 FOR EU-SP-5874PBF RECESSED MOUNT INSTRUCTIONS.

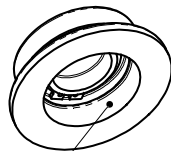

\* 6 APPLY 1 DOT OF  
LOCTITE 222MS  
(WHERE SHOWN)

\* THIS ALSO APPLIES  
TO PBA6/PBA6C

FIGURE 1

**NOTE!**

THIS VALVE IS PRESSURE COMPENSATING.  
BE SURE TO REMOVE ANY EXISTING FLOW  
CONTROL DEVICES. (MAY BE PRESENT IN  
FITTING OR SPUD).

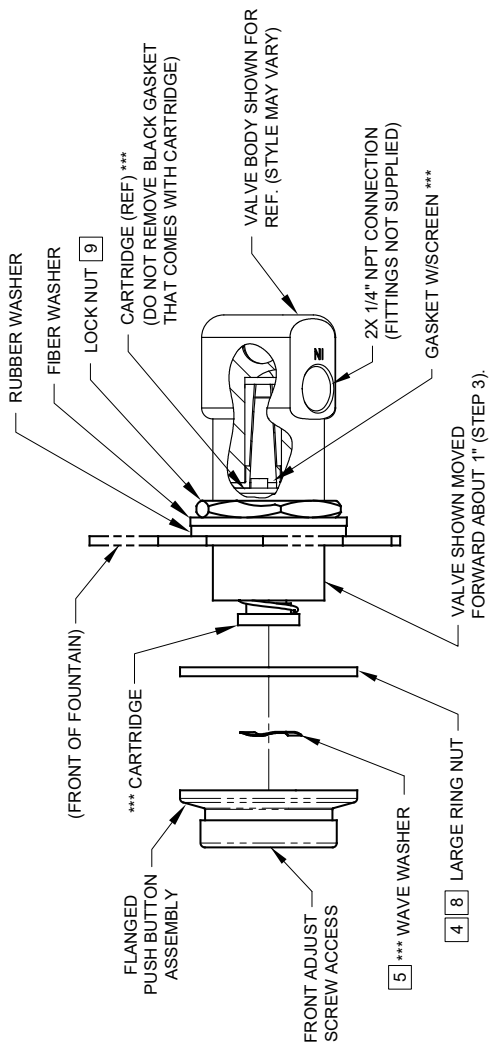

\*\*\* MODEL EU-SP-VRK5874 & EU-SP-VRK5874HF- VALVE REPAIR KITS INCLUDE THESE ITEMS (SEE SHEET 3 OF 3 FOR REPLACEMENT INSTRUCTIONS)

INSTALLATION/REPLACEMENT INSTRUCTIONS FOR EU-SP-5874PBF

- 1) FOLLOW INSTRUCTIONS CAREFULLY ON O&M MANUAL (PAGE 2 OF 7) WHEN REMOVING OLD VALVE. **NOTE: SEE PARTS BREAKDOWN (PAGE 4 OF 7) FOR ADDITIONAL NOTES.**
  - 2) VERIFY THAT LOCK NUT, FIBER, AND RUBBER WASHERS ARE POSITIONED SLIGHTLY PAST MIDWAY OF THREADS ON NEW VALVE BODY.
  - 3) INSERT VALVE INTO BRACKET FROM INSIDE AND PUSH FORWARD ABOUT 1".
  - 4) THREAD LARGE RING NUT ONTO VALVE BODY, APPROXIMATELY 1" INTO VALVE.
  - 5) PLACE WAVE WASHER INSIDE OF FLANGED PUSH BUTTON ASSEMBLY (**MUST ALWAYS BE IN PLACE**).
  - 6) APPLY ONE (1) DOT OF LOCTITE 222MS, ON THE FEMALE THREADS OF BUTTON ASSEMBLY LEAVING THE FIRST AND LAST THREADS FREE. (FIGURE 1). **CAUTION: EXCESS LOCTITE CAN CAUSE THREADS TO LOCK VERY TIGHTLY, MAKING REPAIRS DIFFICULT.**
  - \*\*7) THREAD FLANGED PUSH BUTTON ASSEMBLY ON VALVE UNTIL WAVE WASHER MAKES SLIGHT CONTACT WITH STEM OF CARTRIDGE. **CAUTION: DO NOT HAND-TIGHTEN.**
  - 8) UNTHREAD RING NUT FORWARD UNTIL IT STOPS FLUSH WITH PUSH BUTTON ASSEMBLY.
  - 9) PUSH VALVE BACK TOWARD THE INSIDE OF BRACKET AND TIGHTEN LOCKNUT (SEE ILLUSTRATION ABOVE).
  - 10) TIGHTEN PUSH BUTTON ASSEMBLY USING UNIVERSAL SPANNER WRENCH PROVIDED WITH MODEL 5874PBF.
- \*\* OVERTIGHTENING WILL PRE-ACTUATE VALVE AND CAUSE WEPPAGE, WHILE NOT ENOUGH CONTACT BETWEEN WAVE WASHER AND STEM CAN CAUSE A LOW FLOW CONDITION.

© 2023 Haws® Corporation - All Rights Reserved. HAWS® and other trademarks used in these materials are the exclusive property of Haws Corporation.

Date de révision du document : 02 juillet 2024 - Avis de non-responsabilité : Les améliorations continues du produit font que les spécifications peuvent être modifiées sans préavis. Document et photos non contractuelles. July 02, 2024 - Disclaimer: Continued product improvements make specifications and measurements subject to change without notice. Non-contractual document.

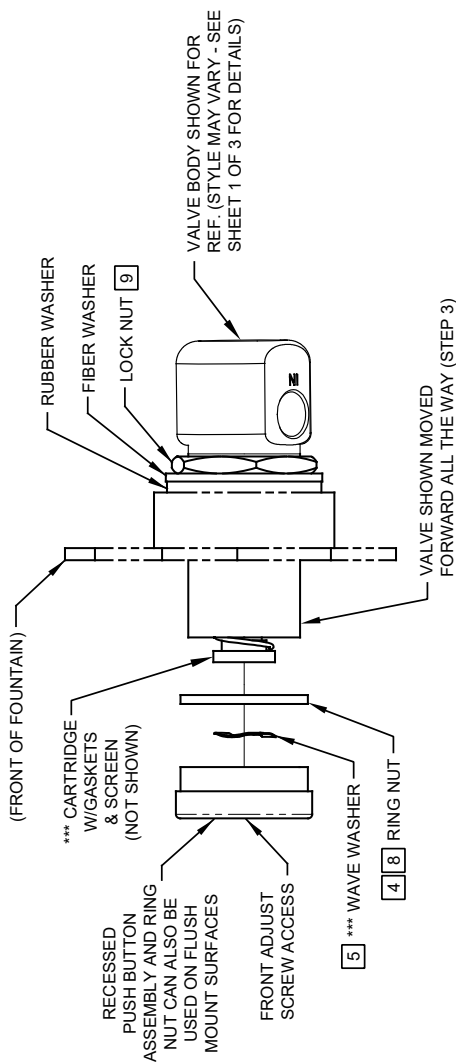

ASSEMBLED EU-SP-5874PB  
(RECESSED MOUNT APPLICATION SHOWN)  
SEE SHEET 1 OF 3 FOR FLUSH MOUNT INSTRUCTIONS.

### INSTALLATION/REPLACEMENT INSTRUCTIONS FOR EU-SP-5874PB

\*\*\* MODEL EU-SP-VRK5874 & EU-SP-VRK5874HF- VALVE REPAIR KITS INCLUDE THESE ITEMS (SEE SHEET 3 OF 3 FOR REPLACEMENT INSTRUCTIONS)

- 1) FOLLOW INSTRUCTIONS CAREFULLY ON O&M MANUAL (PAGE 2 OF 7) WHEN REMOVING OLD VALVE. **NOTE: SEE PARTS BREAKDOWN (PAGE 4 OF 7) FOR ADDITIONAL NOTES.**
- 2) VERIFY THAT LOCK NUT, FIBER WASHER, AND RUBBER WASHERS ARE POSITIONED TOWARD BOTTOM END OF THREADS ON NEW VALVE BODY.
- 3) INSERT VALVE INTO BRACKET FROM INSIDE, AND PUSH ALL THE WAY FORWARD (SEE ILLUSTRATION ABOVE).
- 4) THREAD RING NUT ONTO VALVE BODY, AS FAR IN AS POSSIBLE, TOWARD FRONT OF FOUNTAIN. **NOTE: IF REPLACING A EU-SP-5871 OR EU-SP-5872 SERIES VALVE, YOU MAY HAVE TO CONTACT HAWS TECHNICAL SUPPORT. PLACE WAVE WASHER INSIDE OF PUSH BUTTON ASSEMBLY (MUST ALWAYS BE IN PLACE).**
- 5) APPLY ONE (1) DOT OF LOCTITE 222MS, ON THE FEMALE THREADS OF BUTTON ASSEMBLY LEAVING THE FIRST AND LAST THREADS FREE. (FIGURE 1). **CAUTION: EXCESS LOCTITE CAN CAUSE THREADS TO LOCK VERY TIGHTLY, MAKING REPAIRS DIFFICULT.**
- \*\*7) THREAD PUSH BUTTON ASSEMBLY ON VALVE UNTIL WAVE WASHER MAKES SLIGHT CONTACT WITH STEM OF CARTRIDGE. **CAUTION: DO NOT HAND-TIGHTEN.**
- 8) UNTHREAD RING NUT FORWARD UNTIL IT STOPS FLUSH WITH PUSH BUTTON ASSEMBLY.
- 9) PUSH VALVE BACK TOWARD THE INSIDE OF BRACKET AND TIGHTEN LOCKNUT (SEE ILLUSTRATION ABOVE).
- 10) TIGHTEN PUSH BUTTON ASSEMBLY USING UNIVERSAL SPANNER WRENCH PROVIDED WITH MODEL EU-SP-5874PB. \*\* OVERTIGHTENING WILL PRE-ACTUATE VALVE AND CAUSE WEEPAGE. WHILE NOT ENOUGH CONTACT BETWEEN WAVE WASHER AND STEM CAN CAUSE A LOW FLOW CONDITION.



FIGURE 1

\* [6] APPLY 1 DOT OF LOCTITE 222MS (WHERE SHOWN)

\* THIS ALSO APPLIES TO PBA7/PBA7C

### NOTE!

THIS VALVE IS PRESSURE COMPENSATING. BE SURE TO REMOVE ANY EXISTING FLOW CONTROL DEVICES. (MAY BE PRESENT IN FITTING OR SPUD).

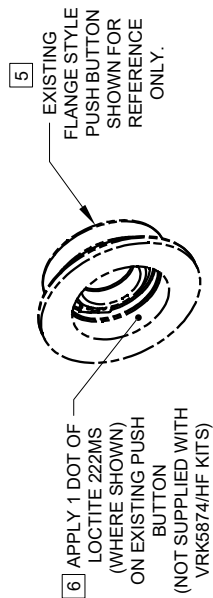

FIGURE 1

### REPLACEMENT INSTRUCTIONS FOR EU-SP-VRK5874 / EU-SP-VRK5874HF

1) FOLLOW INSTRUCTIONS CAREFULLY ON O&M MANUAL (PAGE 2 OF 7) WHEN REMOVING VALVE.  
**NOTE: SEE PARTS BREAKDOWN (PAGE 4 OF 7) FOR ADDITIONAL NOTES.**

2) REMOVE FRONT PUSH BUTTON (WITH WAVE WASHER INSIDE) AND RETAINING NUT WITH THE UNIVERSAL SPANNER WRENCH (PN 0006983506 - NOT SUPPLIED WITH EU-SP-VRK5874 AND EU-SP-VRK5874HF KITS).

3) PULL EXISTING CARTRIDGE ASSEMBLY WITH GASKET SCREEN OUT.

4) WHEN INSERTING NEW CARTRIDGE ASSEMBLY WITH GASKET SCREEN, FOLLOW THESE IMPORTANT STEPS:

- MAKE SURE THERE IS NO DEBRIS IN THE VALVE BODY BEFORE INSERTING THE CARTRIDGE ASSEMBLY INTO THE VALVE BODY.
- ALIGN STRAINER WITH LARGE HOLE IN THE VALVE BODY AND ENSURE THE OUTLET PORT ON CARTRIDGE IS ALSO PROPERLY ALIGNED WITH SMALLER OPENING IN VALVE BODY BY TURNING SLIGHTLY INTO PLACE.
- CONFIRM CARTRIDGE HAS BOTTOMED OUT PROPERLY BEFORE INSTALLING RETAINING NUT.
- THREAD RETAINING NUT UNTIL IT CONTACTS THE CARTRIDGE, THEN TIGHTEN 1-1/4 TURN FURTHER, CHECK FOR LEAKS.
- **(CAUTION: WHEN REPLACING CARTRIDGE W/GASKET ASSEMBLY, DAMAGE CAN OCCUR IF NOT PROPERLY RE-INSTALLED).**

5) PLACE WAVE WASHER (EXISTING OR NEW) INSIDE OF PUSH BUTTON ASSEMBLY **(MUST ALWAYS BE IN PLACE)**.

6) APPLY ONE (1) DOT OF LOCTITE 222MS, ON THE FEMALE THREADS OF EXISTING BUTTON ASSEMBLY LEAVING THE FIRST AND LAST THREADS FREE. (SEE FIGURE 1). **CAUTION: EXCESS LOCTITE CAN CAUSE THREADS TO LOCK VERY TIGHTLY, MAKING REPAIRS DIFFICULT.**

\*\* 7) THREAD EXISTING PUSH BUTTON ASSEMBLY ON VALVE UNTIL WAVE WASHER MAKES SLIGHT SLIGHT CONTACT WITH STEM OF CARTRIDGE. **CAUTION: DO NOT HAND-TIGHTEN.**

8) TIGHTEN EXISTING PUSH BUTTON ASSEMBLY USING UNIVERSAL SPANNER WRENCH (PN 0006983506 NOT SUPPLIED WITH EU-SP-VRK5874 AND EU-SP-VRK5874HF KITS).

\*\* OVERTIGHTENING WILL PRE-ACTUATE VALVE AND CAUSE WEEPAGE; WHILE NOT ENOUGH CONTACT BETWEEN WAVE WASHER AND STEM CAN CAUSE A LOW FLOW CONDITION.

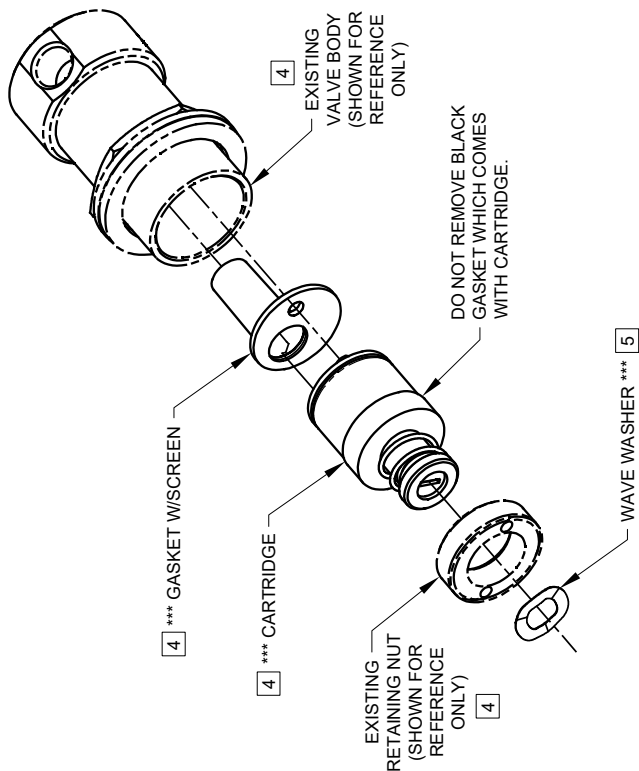

### \*\*\* MODEL EU-SP-VRK5874 & EU-SP-VRK5874HF - VALVE REPAIR KITS INCLUDE THESE ITEMS

#### NOTE!

THIS VALVE IS PRESSURE COMPENSATING. BE SURE TO REMOVE ANY EXISTING FLOW CONTROL DEVICES, (MAY BE PRESENT IN FITTING OR SPUD).